

Instruction Manual

Instruction Manual | Bedienungsanleitung | Manual de instrucciones | Manuale d'istruzioni | Manuel d'instructions |
Handleiding | Návod k použití



H07RN-F/2×1.5
H07RN-F/2×2.5

IP65



MEGAMAN®



www.megaman.cc/user-guide



FFL70800v0+LA11159, FFL70900v0+LA11159, FFL71000v0+LA11159



OFF

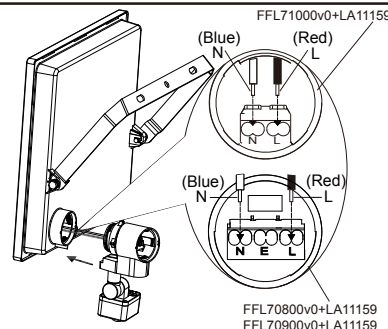
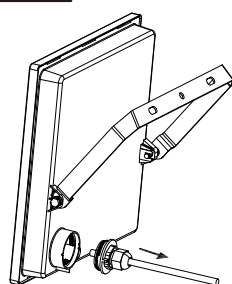
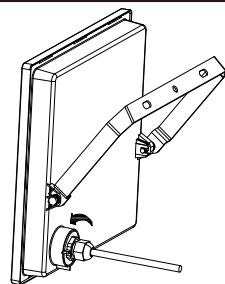

FFL71000v0+LA11159

(Blue) (Red)
N L

(Blue) (Red)
N L

FFL70800v0+LA11159
FFL70900v0+LA11159

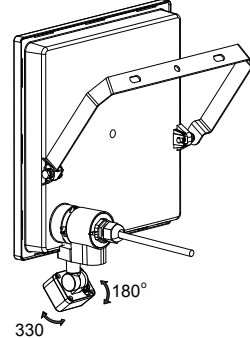
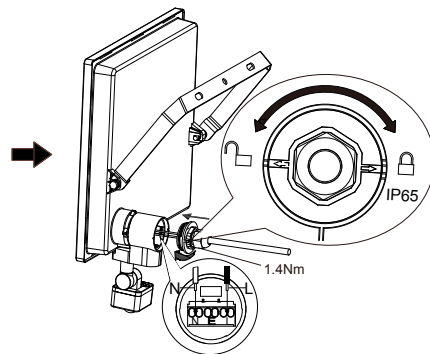
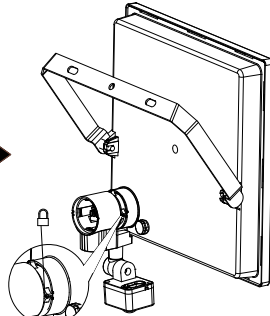
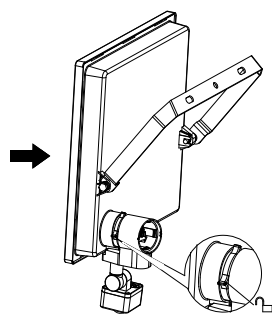

330°

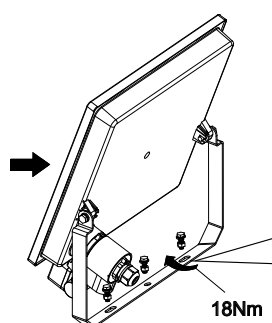

18Nm

Model	A(mm)	B(mm)	C(mm)	screw model
FFL70800v0+LA11159	8.5	66	86	M8
FFL70900v0+LA11159	8.5	66	86	M8
FFL71000v0+LA11159	8.5	150	170	M8

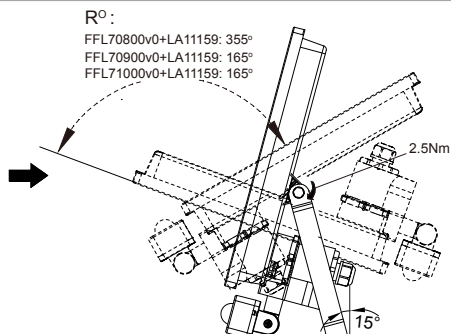

2.5Nm



ON



The light source contained in this luminaire shall only be replaced by the manufacturer or his service agent or a similar qualified person.
Vorsicht - Das Leuchtmittel dieser Leuchte ist nicht austauschbar. Ist das Ende der Lebensdauer des Leuchtmittels erreicht, muss die gesamte Leuchte ausgetauscht werden.
ATENCIÓN - La fuente de iluminación de esta luminaria no se puede sustituir; cuando la fuente de iluminación alcance el final de su vida útil, se deberá sustituir la luminaria completa.
Attenzione - La sorgente luminosa di questo apparecchio non è sostituibile; quando la sorgente luminosa giunge al termine della vita operativa, sostituire l'intero apparecchio.
ATTENTION - La source lumineuse de ce luminaire n'est pas remplaçable; lorsque la source lumineuse atteint sa fin de sa vie, le luminaire entier doit être remplacé.
Voorzichtig - De lichtbron van deze lamp kan niet worden vervangen; wanneer de lichtbron het einde van zijn levensduur bereikt heeft, moet de hele lamp worden vervangen.
POZOR! - Zdroj světla v tomto svítidle není vyměnitelný. Jakmile uplyne jeho doba životnosti - svítidlo jako celek by mělo být vyměněno.



If the external flexible cable or cord of this luminaire is damaged, it shall be exclusively replaced by the manufacturer or his service agent or a similar qualified person in order to avoid a hazard.
Falls das externe flexible Kabel dieser Leuchte beschädigt ist, muss es zur Vermeidung von Gefahren vom Hersteller oder dessen Servicemitarbeitern oder einer ähnlich qualifizierten Person ausgetauscht werden.
para evitar riesgos, si el cable flexible externo de esta luminaria está dañado, debe reemplazarlo el fabricante o su representante técnico, u otra persona de cualificación similar.
Se il cavo esterno flessibile è danneggiato, farlo sostituire dal produttore, dal servizio assistenza o da personale qualificato per evitare qualsiasi pericolo.
si le câble ou le cordon extérieur souple de ce luminaire est endommagé, il doit être remplacé exclusivement par le fabricant ou son agent de maintenance ou toute personne de qualification équivalente, cela afin d'éviter tout risque.
Als de externe flexibele kabel of draad van deze lamp is beschadigd, dan moet deze worden vervangen door de fabrikant of service-agent of een persoon met gelijkwaardige kwalificaties om kans op letsel te voorkomen.
Je-li externí přívodní kabel poškozen, musí být vyměněn pouze elektrikářem, nebo servisním agentem výrobce.

Instruction Manual

Instruction Manual | Bedienungsanleitung | Manual de instrucciones | Manuale d'istruzioni | Manuel d'instructions |
Handleiding | Návod k použití

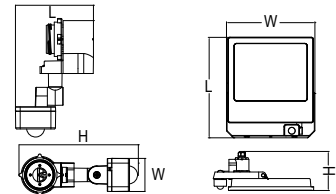
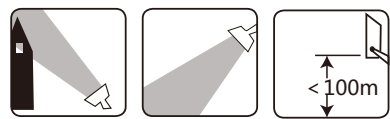

	P	I	Project area (cm ²)	Weight (kg)	Ambient Temperature Range	L (mm)	W (mm)	H (mm)
LA11159	0.5W	N/A	N/A	0.13	-30 °C~+50 °C	99	42	151
FFL70800v0+LA11159	25W	150mA	467	0.53	-30 °C~+50 °C	242	197	128
FFL70900v0+LA11159	45W	280mA	320	0.67	-30 °C~+50 °C	250	197	128
FFL71000v0+LA11159	85W	530mA	467	1.61	-30 °C~+50 °C	338	297	131

PIR sensor specification:

Detection distance:	Max.diameter 6m
Mounting height:	1 - 3m
Hold time:	Min. 10 ± 5 s, Max. 12 ± 2 Min
Day light sensor:	Lux Min.: 20lx , Lux Max.:800lx

Setting :

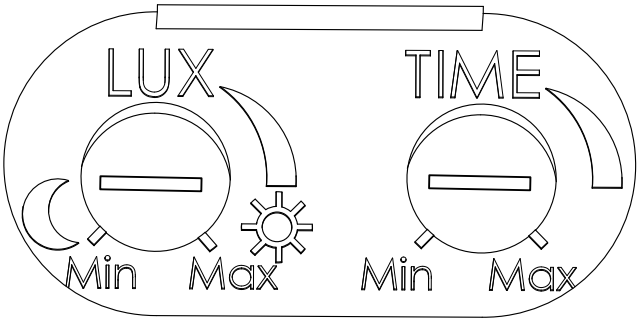

Detection range:

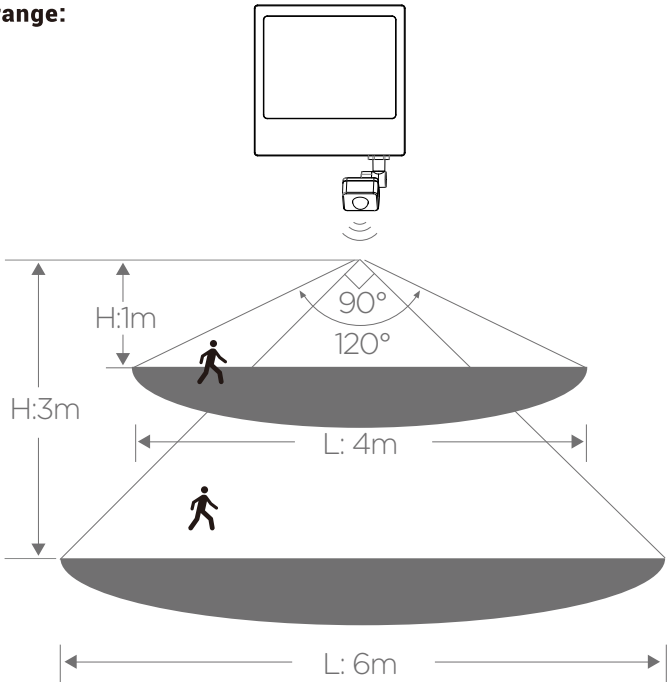

Correct Disposal of This Product

This marking indicates that this product should not be disposed with other household wastes throughout the EU. To prevent possible harm to the environment or human health from uncontrolled waste disposal, recycle it responsibly to promote the sustainable reuse of material resources. To return your used device, please use the return and collection systems or contact the retailer where the product was purchased. They can take this product for environmental safe recycling.